

## ATTENTION – SAFETY REQUIREMENTS

- The correct installation and use of this cycle carrier is the sole responsibility of the user.
  - Weight and maximum capacity of “ZX304” cycle carrier:
    - Model ZX304 (17.50 kg)
    - > 4 cycles, **max. capacity 60 kg**. Max individual cycle weight 15 kg.
  - Never exceed the vehicle manufacturer’s static nose weight.
- The combined weight of the cycle carrier and the load must never exceed the permitted capacity. Keep the towball ball surface clean from dirt and oil.
- Remove from the transported cycles children’s seats, transport baskets, rain covers or other elements that could get lost or increase the air resistance.
  - The cycle carrier is only suitable for transporting bicycles.
  - Before leaving, check that the rear lights function correctly.  
Also check that the indicator lights work correctly.
  - Ensure that the cycle carrier is fitted correctly on the towball and that the cycles are secured as instructed.
- When on the road, respect the highway code speed limits and pay attention to the road conditions to prevent jolts.
- Be aware that the loaded cycle carrier may change the driving characteristics of the car while braking, during windy conditions and whilst cornering.
  - To avoid damage, if the boot lid is equipped with an automatic opening function, use this function with care.
  - Check all the cycle carrier fixing elements after a short while, then at regular intervals whilst on your journey.
  - Take care when reversing and parking because of the greater length of the car.
  - Check the distance between the cycle carrier, the cycles and the exhaust pipe(s) to avoid heat damage.
  - To increase road safety and to reduce fuel consumption, remove the cycle carrier when not in use.
  - Modifications to the cycle carrier and its components are not permitted.
  - Immediately replace any worn or damaged parts using only original spare parts.
  - The cycle carrier can be cleaned using warm water and/or car shampoo.
  - Store the cycle carrier in dry conditions at moderate temperatures.

The manufacturer is not responsible for damage caused by improper use of this product, nor for any objection made by the competent authorities with regard to the highway code.

The manufacturer shall only be responsible for manufacturing defects in the cycle carrier and accessory components.

# CYCLE CARRIER SYSTEMS

ASSEMBLY AND USER INSTRUCTIONS v1



## ZX304 Cycle Carrier



Rear cycle carrier for mounting onto a towball.

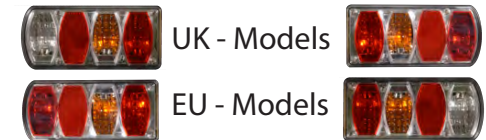

GB

ASSEMBLY AND USER INSTRUCTIONS v1

Whenever this product is used the following information must be taken into consideration:

The cycle carrier is a safe product IF used correctly, whereas if it is used incorrectly it can cause damage to you, your vehicle and anyone driving behind you.



Tools required for initial assembly:

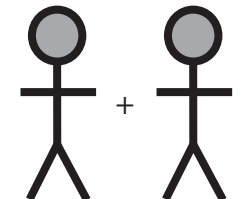
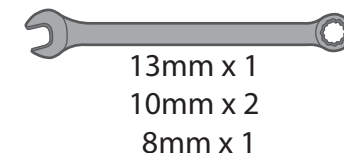
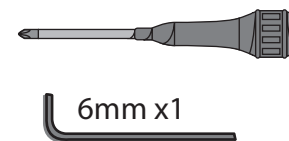

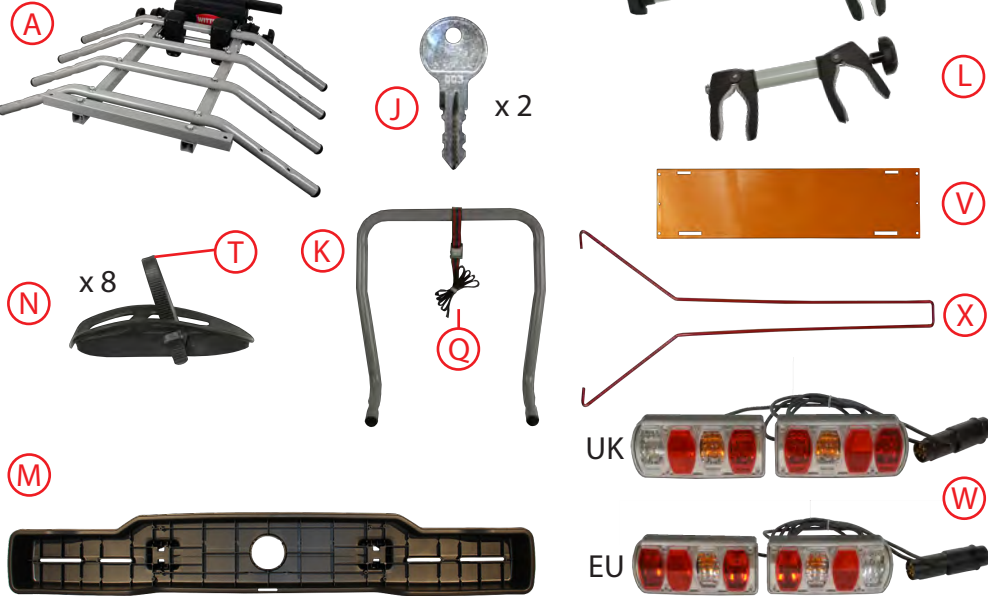
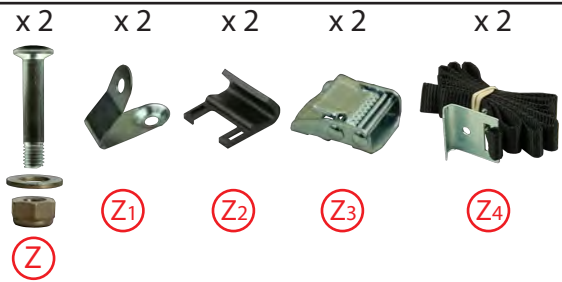
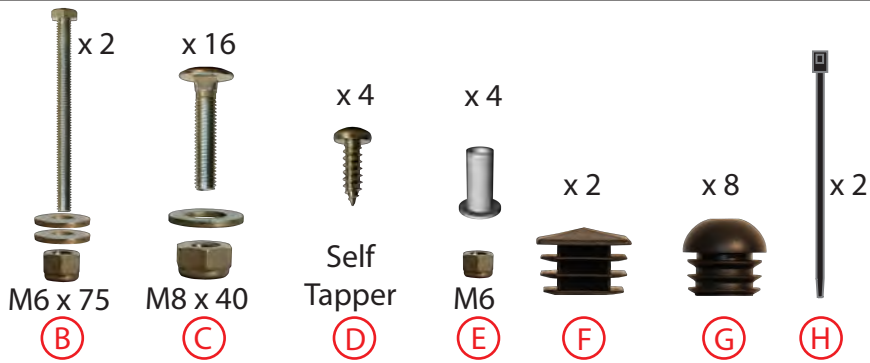

Replacement Parts: When ordering please prefix with the model number

	Prefix	Part	Amount
Example:	ZX412	D	x4

To tilt the cycle carrier first loosen the support straps and un-hook from the vehicle. Hold up/take the weight of the carrier with one hand while you pull the red release handle with the other. To avoid injury or damage, this operation of tilting the cycle carrier should be carried out **with assistance**. To close the cycle carrier lift until the red release handle and mechanism **click** and **engage securely** in the transit position.

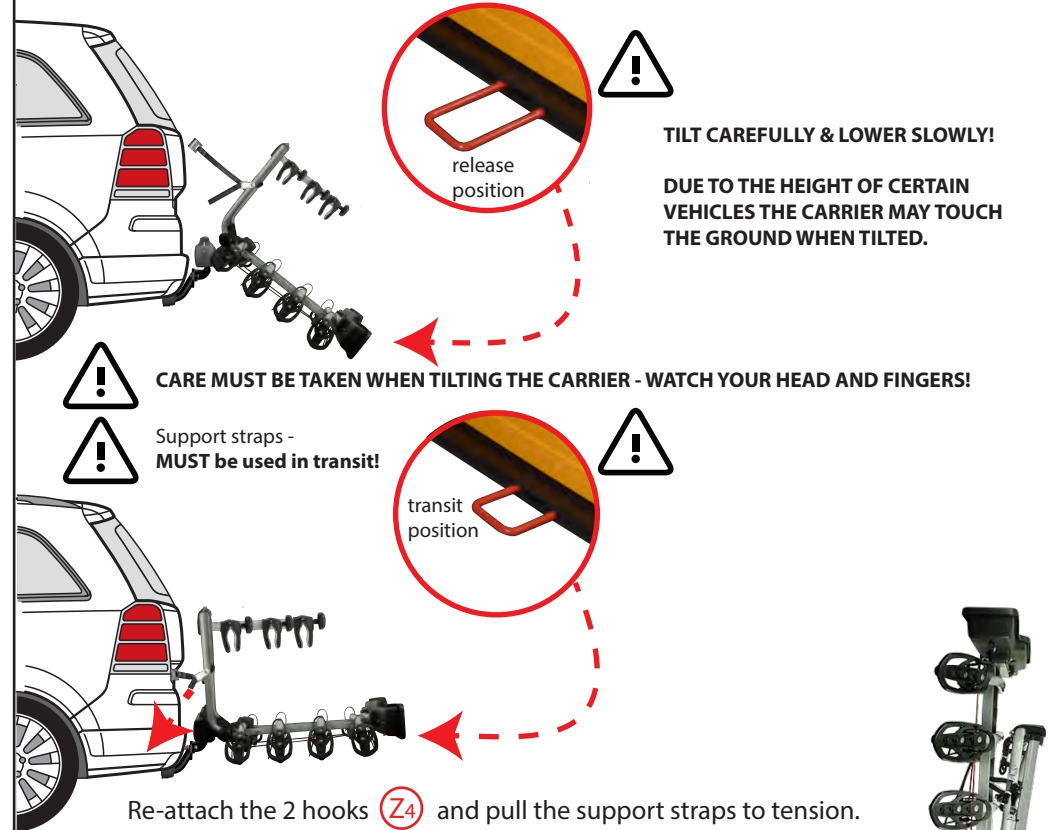

**Please Note:** The Cycle support arm conveniently folds flat to aid storage of the carrier when not in use.

Optional Locks available:

Order Ref: ZX412  
(4 Lockable hand wheels)



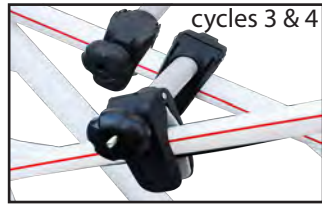
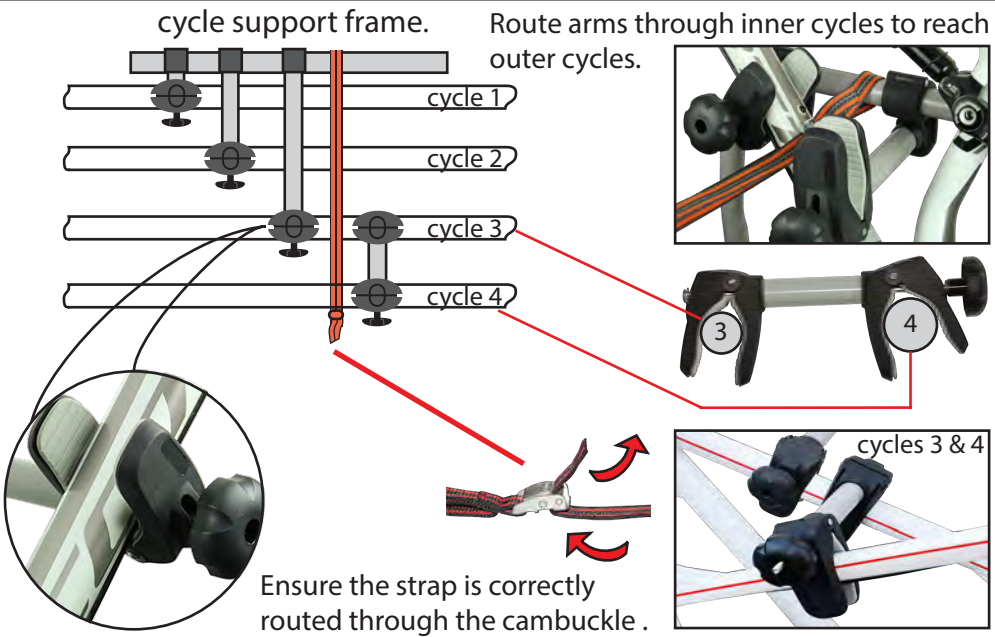

Secure wheels into the wheel locators by feeding the strap into the buckle and pulling down until tight.

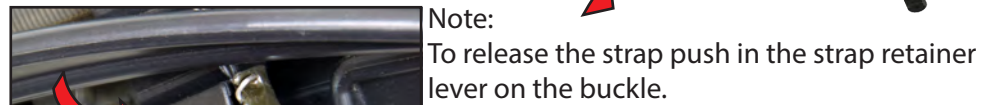

**CHECK!** cycles & carrier are secure before your journey, then at regular intervals whilst on your journey.

1. Check towbar nose weight in your vehicle handbook(s-vertical static mass). The sum of weights of cycles and carrier (17.50kg) must not exceed this amount. Never exceed this limit.

? KG

Vehicle Handbook

**IMPORTANT!**

2. Insert Square plugs.

x 2

F

page 3

Insert Round plugs.

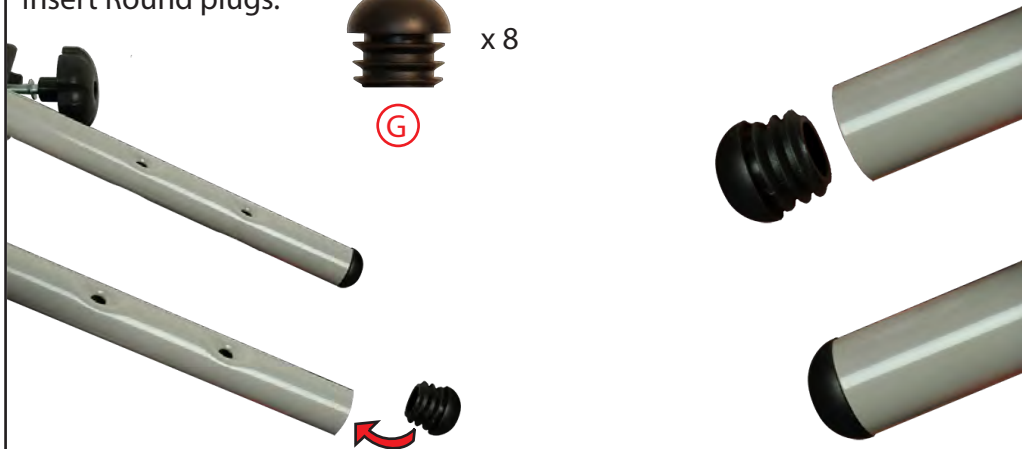

Gently knock the end plugs into the tube. Use a rubber mallet.

3. You may want to mount the base unit at this point onto the towball to aid access and stabilise the assembly.  
If so, please follow the mounting instructions on page 11 & 12.

4. Fitting the Wheel Locators.

Please Note:  
Adjust the locators to the length of the cycles to be fitted.

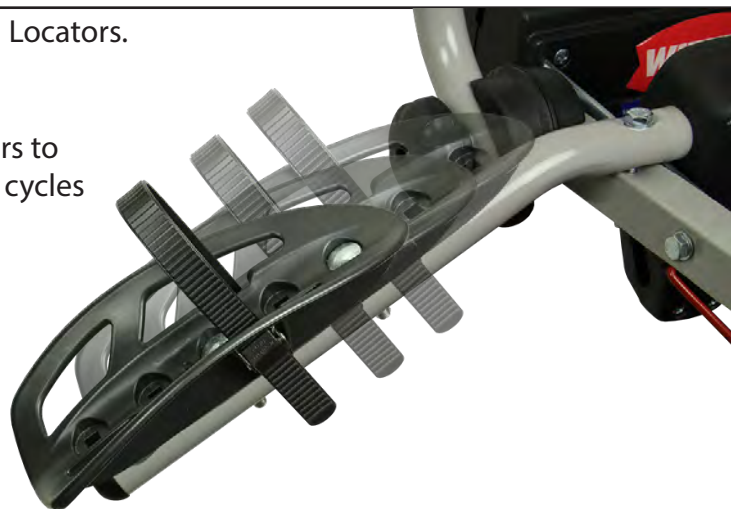

9. Attach the plug to the vehicle using the appropriate 7 or 13 pin electrical connection. Ensure the plug is fully inserted and that the cable cannot touch the floor. Fit the protective cap to the end not being used.



Please Note: If using the 7 pin connection the reversing light will not function.

**IMPORTANT:** Check light function! Check all fixtures and bolts!

10. Positioning and fixing the cycles on the carrier.

**Cycle 1:**

Place the biggest/**heaviest** cycle on the carrier first, closest to the vehicle. Position the wheels into the wheel locators with the fixing arm (P) attached at one end to the cycle support frame and to the cycle frame at the other. Secure the wheels in the wheel locators using the ratchet straps (T).

**Cycle 2:**

Fits in the 2nd set of wheel locators with the fixing arm (S) attached at one end to the cycle support frame and to the cycle frame at the other. Secure the wheels in the wheel locators using the ratchet straps (T).

**Cycle 3:**

Fits in the 3rd set of wheel locators with the fixing arm (R) attached at one end to the cycle support frame and to the cycle frame at the other. Secure the wheels in the wheel locators using the ratchet straps (T).

**Cycle 4:**

Fits in the outer locators (this should be the smallest/lightest bike) using the bike to bike clamp arm (L) attached to the bike frame from the previous bike frame.

Secure the wheels in the wheel locators using the ratchet straps (T).

**CHECK ALL FIXING ARMS ARE SECURE!**

**IMPORTANT:**

As an extra safety precaution the cycle carrier is fitted with a belt (Q) for anchoring all the cycles to the cycle support frame. **Ensure** this belt is used and check it is mounted correctly by pulling on it.

Check the main cycle platform is level before closing the clamp.  
Check the towball locator is secured to the hitch ball.

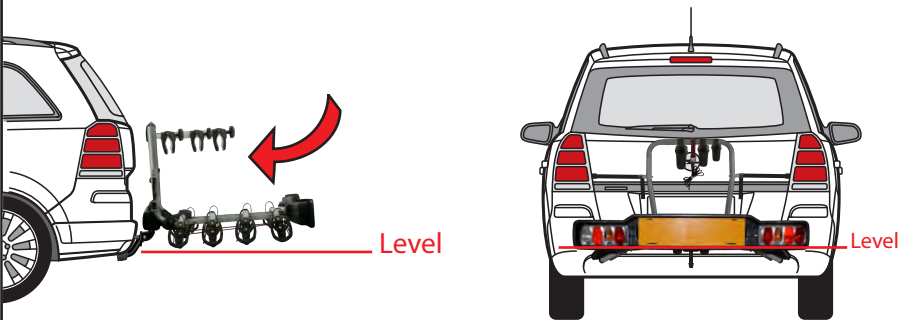

**IMPORTANT:**

**Once level, attach and tension the support straps.**

Attach the protective plastic cover (Z2) to the strap hook (Z4).

Attach hooks to vehicle tailgate/boot at a suitable point ensuring the position is stable and strong enough to hold the weight of the carrier and cycles.

**Do Not attach to plastic trimming or glass window!**

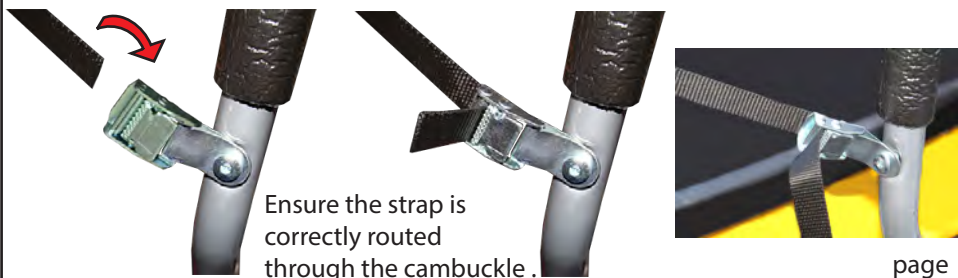
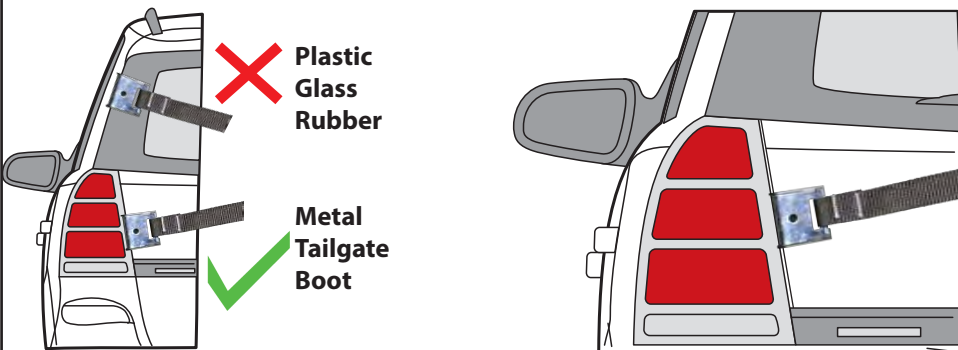

**Fitting the wheel locators to the cycle carrier bars.**



16 x M8 x 40mm bolt,  
16 x M8 Nyloc nuts,  
16 x M8 flat washers,

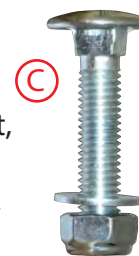

Torque settings M8 = 8 Nm



### 5. Light board assembly -

Attach the light units using the spacer tube and Nyloc nut "E" (x4).  
 Ensure the light units are the correct way round (UK/EU).  
 Guide rear bolts of each light unit through the light board fixing slots.

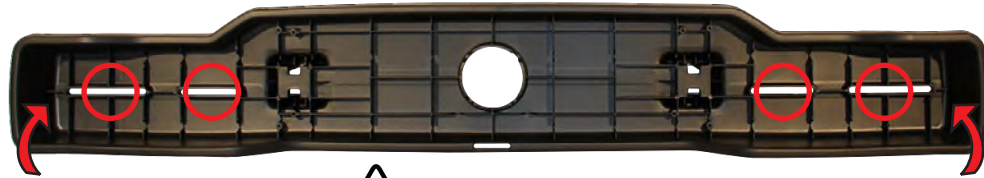

LH



**IMPORTANT**

UK - Light Configuration



RH



EU - Light Configuration

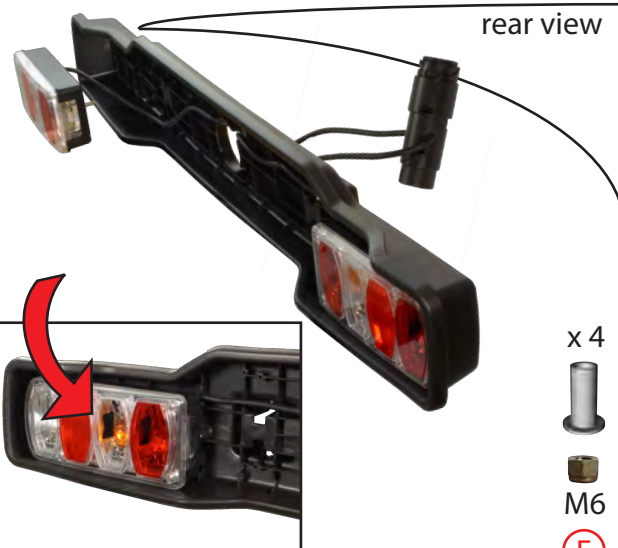

rear view

x 4



M6



Do not over tighten.

### 8. Mount the cycle carrier. To mount the cycle carrier safely and to avoid damaging the vehicle, you should request the help of another person.

Lift the clamp lever until the towball locator is completely open. To lift the lever turn the key anti-clockwise and hold the key until the lever is released.

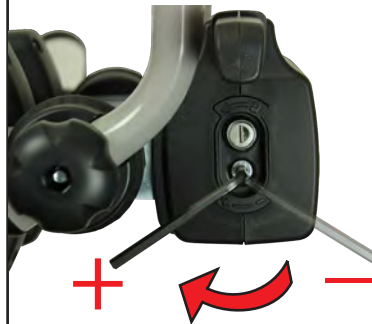
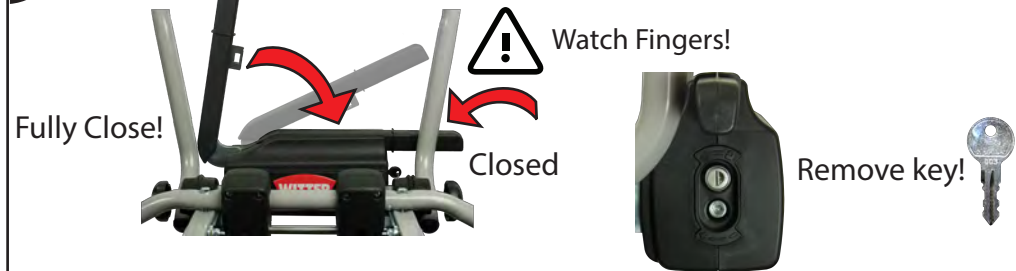
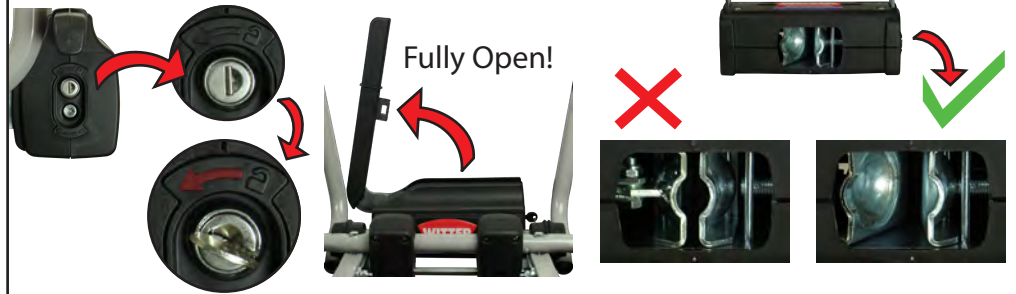

### **IMPORTANT!**

It may be necessary to tension the clamp lever for the initial fitting and at subsequent intervals during the life of the carrier.

If the clamp lever is fully closed and the carrier has excess movement on the ball or the lever will not close due to the clamp being too tight, the tension screw needs adjusting accordingly. Fully open the handle to make adjustments, then try fitment again.

7. Mount the cycle support frame.

The support frame is best fitted at 90° to the platform.

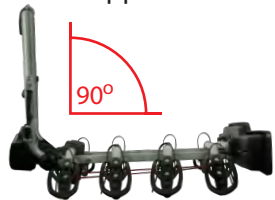

Ensure teeth engage fully home.

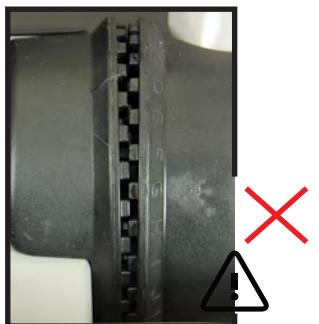
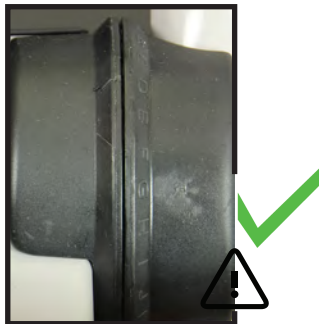

Assemble the fixing arms as per instructions within the arm packaging.



x 4 Self Tapper (D)

Push the 13 pin plug through the centre hole, route wires into the cable channels.



Ensure wires are not trapped! Mount number plate frame using screws (D).



Carefully attach the release handle (X).

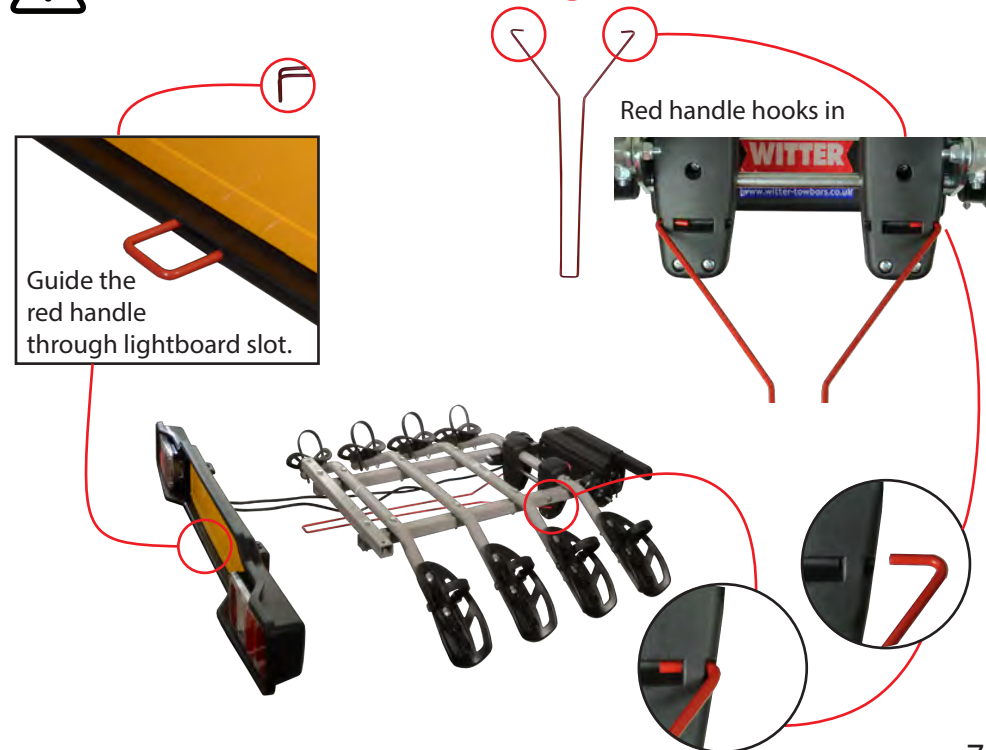

Locate the red handle through the lightboard slot.



Ensure the hooks are still engaged!



Secure the lightboard to the carrier with bolts "B" placing a washer at the top and bottom. Tighten the Nyloc nut to 4 Nm.

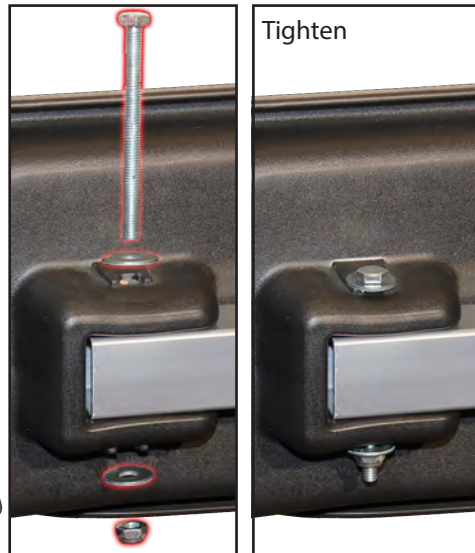

Route the cable carefully down the sub frame. Cable tie in position and ensure the cable length is correct.

Ensure the carrier can tilt freely without trapping or causing stress to the cable!

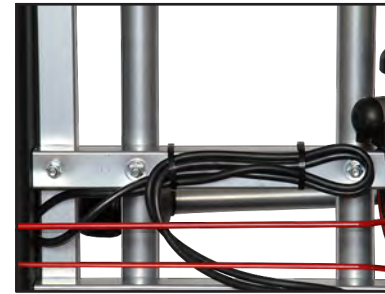

6. Assemble cam buckle and attach to cycle support frame.

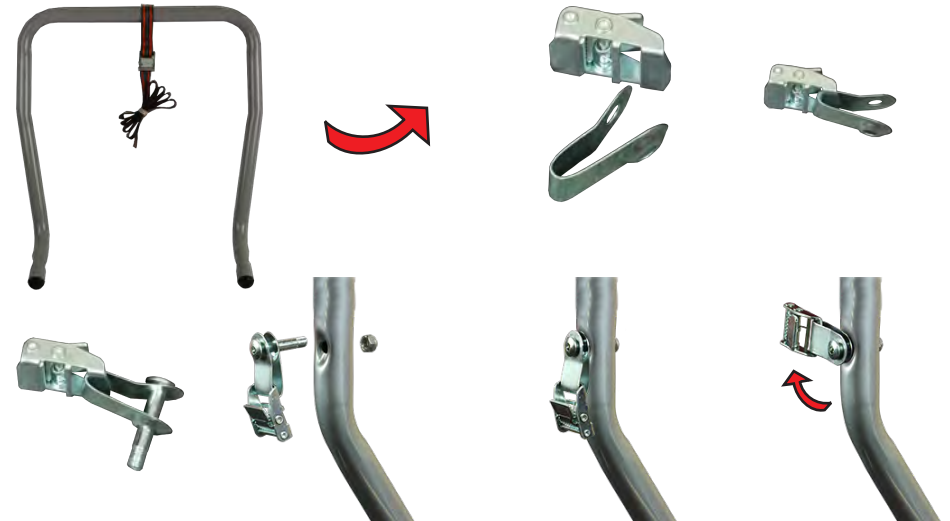

The cam buckle assembly once fully tightened should be able to pivot freely.