



# Fitting Instructions

CL88AU  
TOWBAR  
For Mitsubishi Grandis for  
2004 - CL88Q

## MATERIALS

A	1	Cross Bar
D	2	M12 x 60 x 1.25mm Fine Pitch Bolts, Lock Washers and Flat Washers (25mm O.D.)
E	1	Right Hand Side Arm
F	1	Left Hand Side Arm
G	4	M12 x 30 x 1.25mm Fine Pitch Bolts, Lock Washers and Flat Washers (25mm O.D.)
H	2	M12 x 35 x 1.25mm Fine Pitch Bolts, Lock Washers and Flat Washers (25mm O.D.)
J	4	M12 x 35 x 1.25mm Fine Pitch Bolts, Lock Washers and 2 Nuts
K	4	M12 x 30 x 1.75mm <b>Standard Pitch</b> Bolts and 1 Flat Washer (25mm O.D.)
EP	1	Electrical Plate (ZEP2)
X	2	Exhaust rubbers

## For use with

CL88Q Detachable neck option – ZQ2031. Please refer to ZQ fitting instructions for installation

## FITTING

\*\*\* NOTE THIS TOWBAR HAS DIFFERENT THREAD PITCHES WITHIN THE BOLT KIT, ENSURE CORRECT PITCH IS USED FOR EACH SECTION OF THE FITTING \*\*\*

1. Remove plastic clips from lower edge of bumper. Lower spare wheel and remove spare wheel hanger hook. Remove plastic under tray from left hand side. Remove towing eye from left hand chassis rail and retain for fitment if towbar is removed. Remove 3 rearmost exhaust hanger rubbers and lower exhaust.
2. Loosely attach Side Arms (E) and (F) to captive nuts in chassis rails using Bolts (G). Loosely attach Cross Bar (A) to Side Arms (E) and (F) using Bolts (J). Insert Bolts (D) and (H) from underside of Side Arms (E) and (F).
3. Attach neck (ZQ) and electrical plate angle (EP) as per separate instruction. **NOTE: Replace 4 M12x25 Bolts from detachable kit with Bolts (K) - M12x30x1.75.** Tighten all Bolts.
4. Re-mount exhaust using longer exhaust rubber (X) for rearmost mounts if additional clearance is required. Re-fit plastic under tray and attach lower edge of bumper.

Please refer to the vehicle specification for the trailer weight and nose limits, which **must be observed**.

**Recommended torque settings:** Grade 8.8 bolts: M12 - 80 Nm, M16 - 200 Nm

**Grade 10.9:** M12 – 120Nm, M10 – 70Nm M8- 35Nm

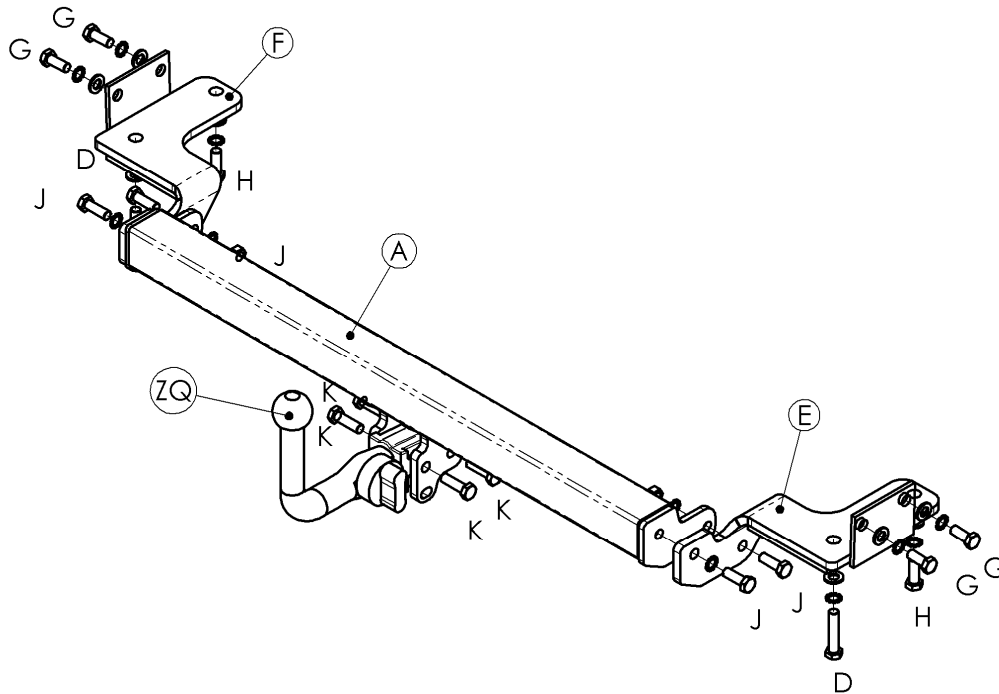

W0001CL88AU-FIT\$010802220000