



Fitting Instructions

Towbar **DT144AU**
For NISSAN QASHQAI
2007-

MATERIALS:

A	1	Cross Bar
D	2	M12 x 40 x 1.75 Bolts, Lock Washers and Plain Washers.
E	3	M10 x 35 x 1.5 Bolts, Lock Washers, Witter Cage Nuts.
F	1	Angle Bracket.
G	1	Chassis stiffener.
H	2	M10 x 35 x 1.5 Bolts, Plain Washers, Nyloc Nuts
J	1	Nut Strap.
K	1	Cage Nut Strap
L	2	M12 x 40 x 1.75 Bolts, 4-off Plain Washers, Nyloc Nuts
ZE	1	Retractable Electrical Plate
SCP	1	Safety Chain Plate

FITTING:

1. Remove bumper (remove clips along lower edge, clips around wheel arch, 1 tip screw and pull back wheel arch extensions to reveal push in clips. Carefully pull bumper backwards to release from clips on rear panel.
2. Remove chassis end caps (3 bolts) and insert Left hand chassis stiffener (G) inside chassis, loosely attach Crossbar (A) to Stiffener (G) using Fasteners (D & H). Loosely attach Stiffener (G) to vehicle chassis using remaining Bolts (D & H).
3. Pre-Assemble Witter Cage Nuts (3-off) to Nut Straps (J & K)
Note: For vehicles built from 2013 onwards use the outer two cage nut holes on Nut Strap (K)
4. Insert Nut straps (J & K) inside right hand chassis opening and loosely attach Crossbar (A) to vehicle chassis using Fasteners (E). Loosely attach Bracket (F) to chassis and Cross Bar (A) using remaining Bolts (E & H).
5. **Fully tighten all bolts.**
6. Refit chassis end caps / bumper beam.
7. Refit bumper.
8. Attach the chosen Neck, Retractable Electrical Plate (ZE) and Safety Chain Plate (SCP) to Cross Bar (A) using the fasteners and instructions from each kit. (Note: Use the longer bolts supplied with the Safety Chain Plate Kit when fitting a Detachable Neck)
9. **Fully tighten all bolts.**

Note: This towbar must be used with either a Witter Towball (part number Z11) or Class A50-1 or A50-X towball dimensionally

Conforming to A50-1 with a 'D' and 'S' value greater than or equal to that of the towbar.

Please refer to the vehicle specification for the trailer weight and nose limits, which **must be observed**.

Recommended torque settings:

Grade 8.8: M8 - 27Nm, M10 - 53 Nm, M12 - 95 Nm, M16 - 214 Nm

Grade 10.9: M12 - 139Nm, M10 - 78Nm

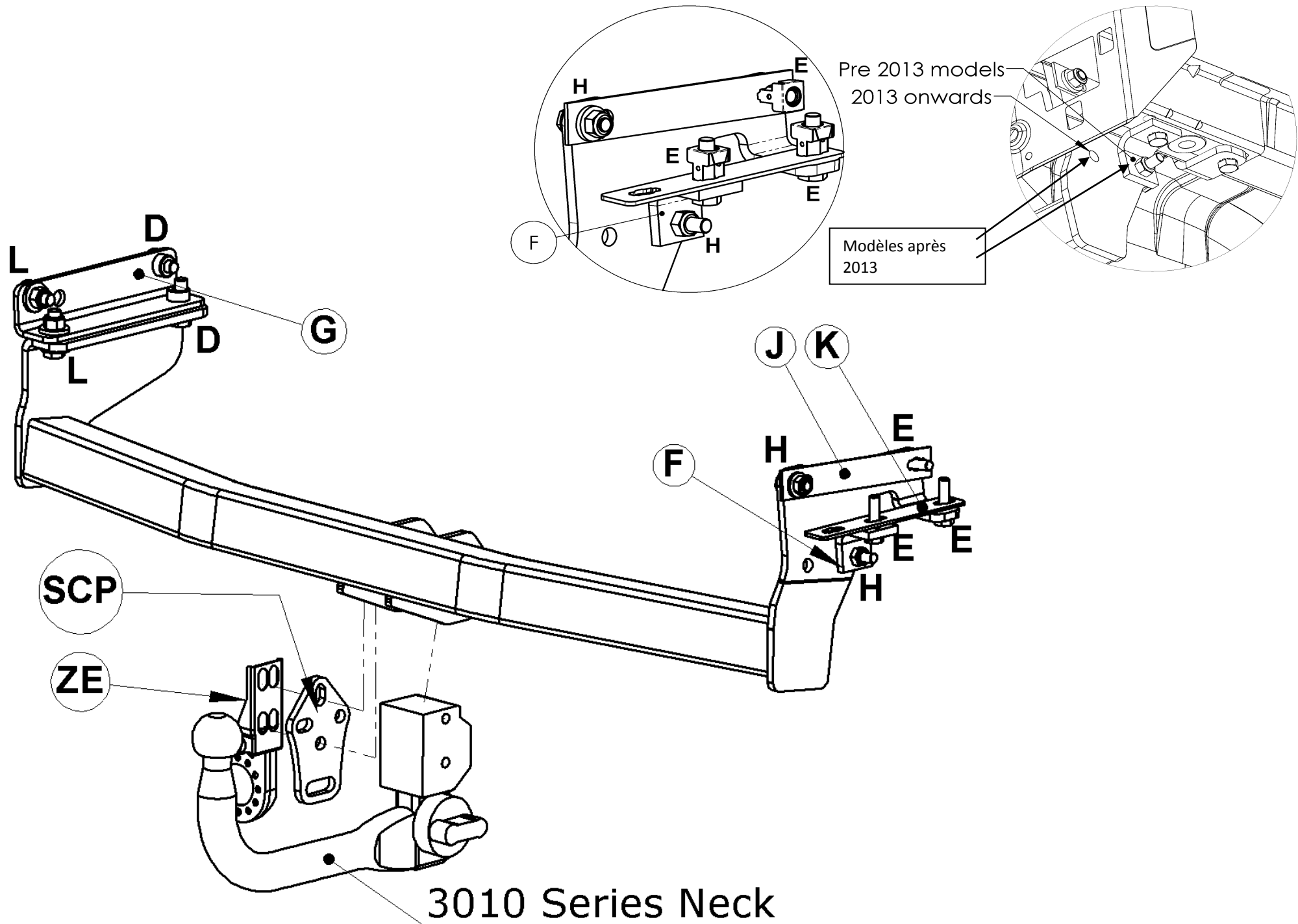

3010 Series Neck