



Fitting Instructions

TOWBAR for **F177U**
Ford S-Max 2015-
Ford Galaxy 2015-

MATERIALS

A	1	Cross Tube
B	2	Side Arm
C	1	Bracket
D	1	Bracket
E	1	Bumper Bracket
F	1	Bumper Bracket
G	6	M12 x 40 x 1.75 Bolts, Flat Washers (30mm O.D.), Lock Washers and Witter Cage Nuts
H	4	M12 x 40 x 1.75 Bolts, Lock Washers and Nuts
J	4	M12 x 40 x 1.75 Bolts, Lock Washers and Nuts
X	4	Existing Steel Bumper Beam fasteners from outer fixing points.
ZE	1	Retractable Electrical Plate
ZN	1	Neck Kit

FITTING

- Remove the Bumper
 - Open the tailgate and prise off the black plastic covers to gain access to the light cluster screws.
 - Remove the light cluster retaining fasteners (2 per cluster) and pull light clusters rearwards from vehicle.
 - Remove the plastic bumper fastener that is exposed after light cluster removal.
 - Remove screws from around wheel arch edge (4 each side of vehicle).
 - Remove the two screws securing the inner lower section of bumper to the internal steel bumper beam.
 - Pull each bumper tip from retaining clips and pull reward to remove.
- Remove Steel Bumper Beam from vehicle rear panel, retaining fasteners for assembly of tow bar.
- Remove the exhaust silencer from it's 4 support rubbers to give access to chassis rail mounting holes.
- Assemble Witter Cage Nuts (G) to each Side Arm (B) (Note which Side Arm face to assemble to from diagram below)
- Insert Side Arms (B) into each chassis rail and loosely secure with fasteners. (G)
- Loosely assembly Brackets (C & D) to the vehicle rear panel using outer steel bumper beam locations and original fasteners (X).
- Loosely assemble Cross Bar (A) between each Side Arm (B) using fasteners (H) (**Use Arm Hole Diagram to clarify holes to use**)
- Loosely assemble Bumper Support Brackets (E & F) to Side Arms (B) using 'Holes number 3' and fasteners (J) – ensuring that the fasteners (J) also pass through Bracket (C & D) (**Use Arm Hole Diagram to clarify holes to use**)
- Assemble the chosen Neck Kit (ZN) and Retractable Electrical Plate (ZE) to Cross Bar (A)
- Fully tighten all fasteners**
- Refit exhaust silencer to it's support rubbers.
- Cut bumper using diagram below as a suggested guide (No Cut required for some neck options – see below).
- Refit bumper.

Recommended torque settings: Grade 8.8 bolts: M8 - 24Nm, M10 - 52 Nm, M12 - 80 Nm, M14 - 130 Nm, M16 - 200 Nm
Grade 10.9: M12 – 120Nm, M10 – 70Nm M8- 35Nm

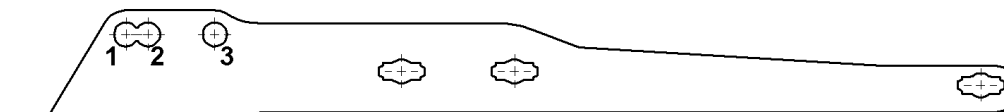

HOLE POSITION	VEHICLE APPLICATION	BUMPER CUT	NECK KIT
1	Galaxy (All models)	Visible	3007 series
2	S-Max (with Spare Wheel)	Visible (all necks)	3006 series
3	S-Max (no Spare Wheel)	NO CUT REQUIRED (except for Detachable)	3007 series



W 0001F177U-FIT\$011501140000

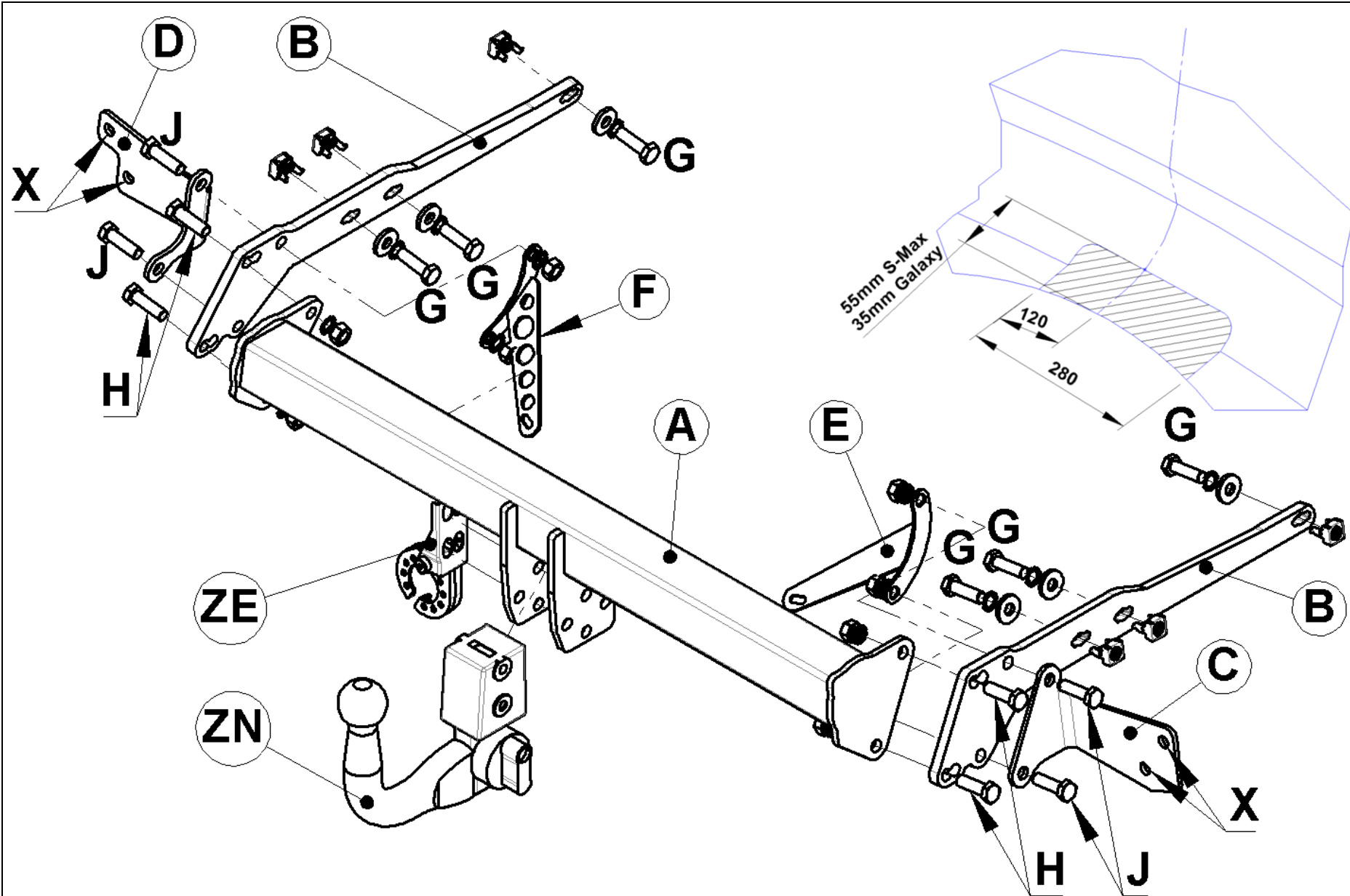

W 0001F177U-FIT\$011501140000