



Fitting Instructions

TOWBAR F182U
For Ford Focus
2018-

MATERIALS

A	1	Cross Tube
B	1	Side Arm
C	1	Side Arm
D	2	M10 x 40 x 1.5 Bolts, Lock Washers and Plain Washer
E	2	M10 x 40 x 1.5 Bolts, Lock Washers, Plain Washer and Nyloc Nut
F	4	M12 x 35 x 1.75 Bolts, Nyloc Nut
ZE	1	Retractable Electrical Plate
ZN	1	Neck option

FITTING

1. Remove the bumper (wheel arch screws, tip screw, 2 bottom edge screws)
2. Remove the bumper beam.
3. Loosely assemble each Side Arm (B & C) inside each chassis rail using fasteners (D & E).
4. Loosely assembly the Cross Bar (A) to Side Arms (B & C) using fasteners (F). Select the appropriate holes from the Side Arm diagram below, depending on the vehicle type.
5. Assemble the chosen Neck kit (ZN), and Retractable Electrical Plate (ZE) to Cross Bar (A) using the respective kit instructions.
6. Cut the bumper, and aluminium shield on the Estate, using the diagrams below as a guide.
7. Refit the bumper.
8. **Fully tighten all fasteners**

Recommended torque settings:

Grade 8.8 bolts: M8 - 24Nm, M10 - 52 Nm, M12 - 80 Nm, M14 - 130 Nm, M16 - 200 Nm

Grade 10.9: M12 - 120Nm, M10 - 70Nm M8- 35Nm

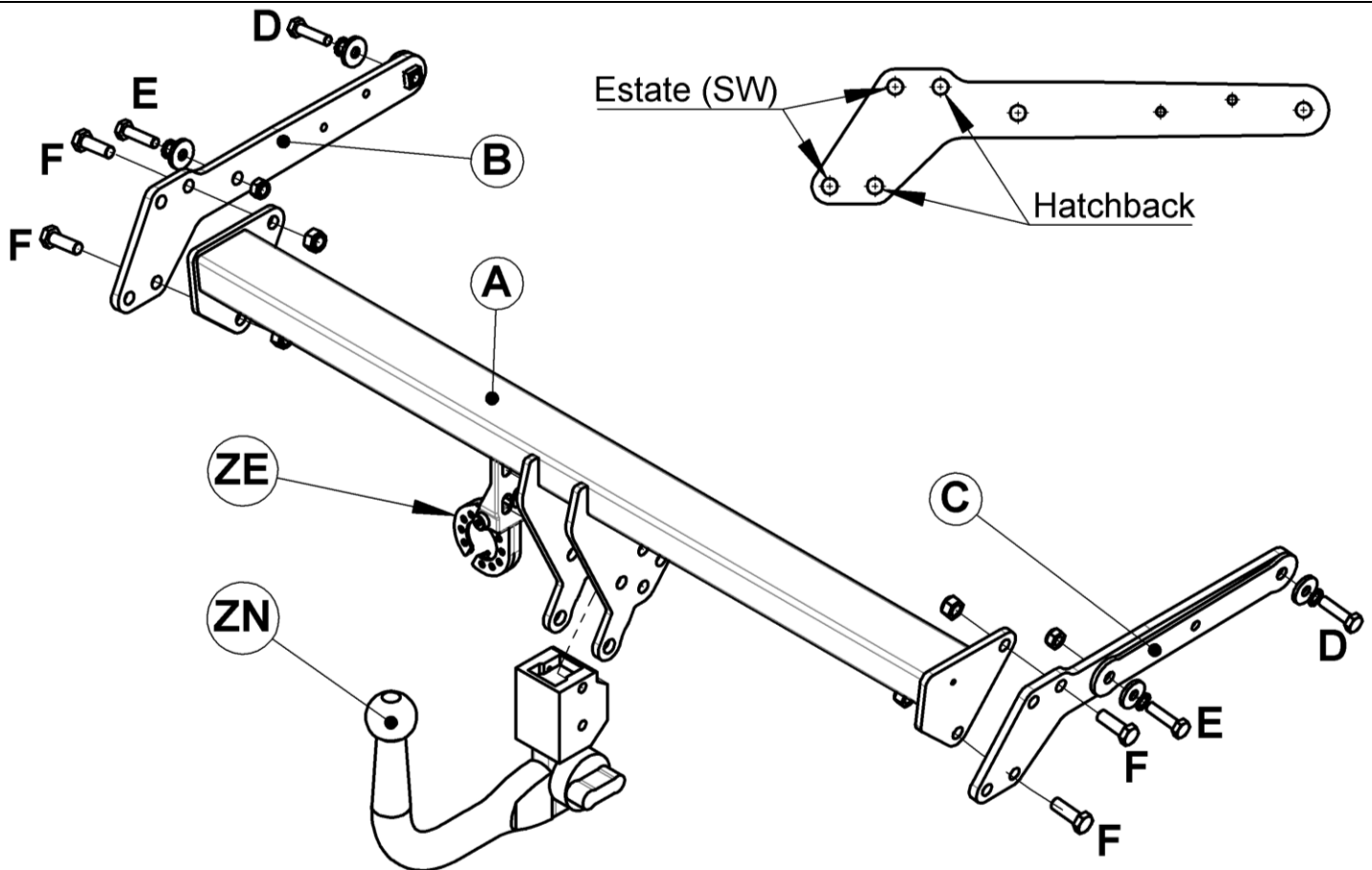

Estate Bumper and Under-tray Cut Information:

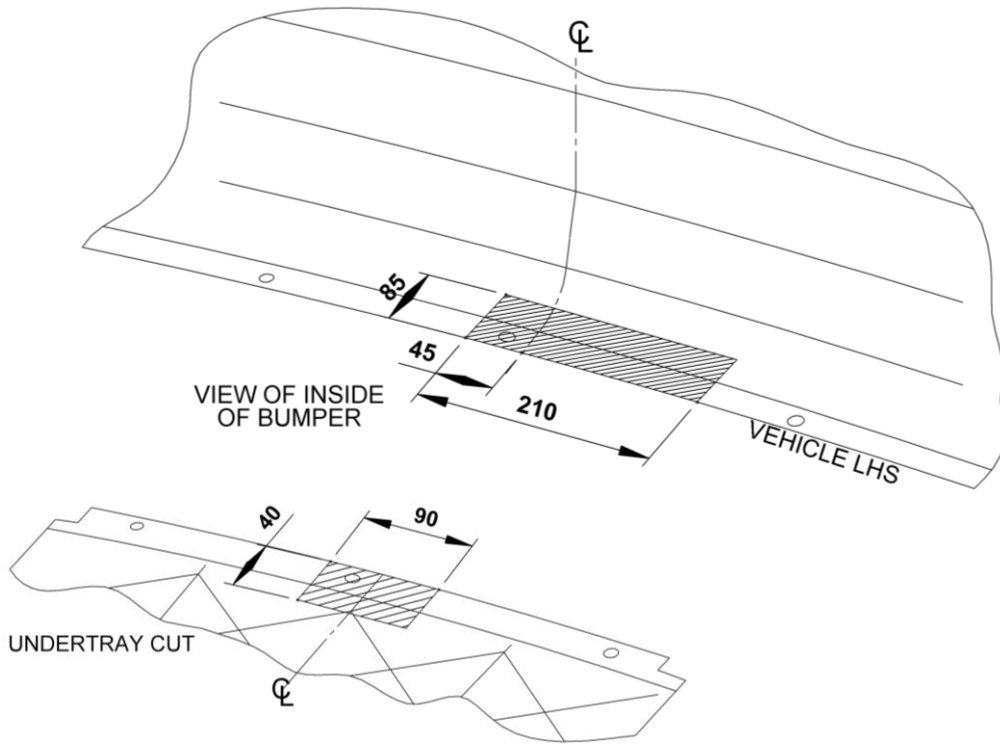

Hatch Bumper Cut Information:

