



# Fitting Instructions

TOWBAR **G87B**  
For VAUXHALL ASTRA  
2004 -

## MATERIALS

A	1	Cross Bar
D	1	LH Spreader Plate
E	1	RH Spreader Plate
F	1	Packer Plate
F1	2	Bushes 19mm O.D, 60 Long
G1	2	Bushes 19mm O.D, 56 Long
H	4	M10 x 100 x 1.5 Bolts, Nuts and Lock Washers
CB	2	M16 x 40mm Coupling Bolts, Nuts, Lock Washers
Z	1	ZEP35 Electrical plate (not shown)

## FITTING

1. Remove rear panel along boot edge, remove boot floor covering, loosen boot side trims and pull to centre to reveal dimples in boot floor.
2. Drill out dimples to sufficient diameter to insert bushes (F1 and G1).
3. Insert bushes (F1 and G1) into chassis. Attach spreader plates (D and E) using bolts (H). **Note:** Ensure good mating surface between spreader plates and boot floor, (any acoustic sound proofing agent must be removed).
4. Lower rearmost exhaust box (2 rubbers) and loosely attach crossbar (A) to Bolts (H) using Nuts (H) taking care not to damage bumper with centre of Cross Bar (A).
5. **Tighten all Bolts** and Refit exhaust hangers (Note: it may be necessary to bend the exhaust hangers down slightly on Sport Models to give sufficient clearance from Cross Bar (A)).
6. **It may be necessary to move the vehicle number plate up in its recess to prevent obscuration by the towball.**

**Note:** This towbar must be used with either a Witter Towball (part number Z11) or Class A50-1 or A50-X towball dimensionally Conforming to A50-1 with a 'D' and 'S' value greater than or equal to that of the towbar.

Please refer to the vehicle specification for the trailer weight and nose limits, which **must be observed**.

**Recommended torque settings:** Grade 8.8 M8 - 27Nm, M10 - 53 Nm, M12 - 95 Nm, M14 - 150 Nm, M16 - 214 Nm

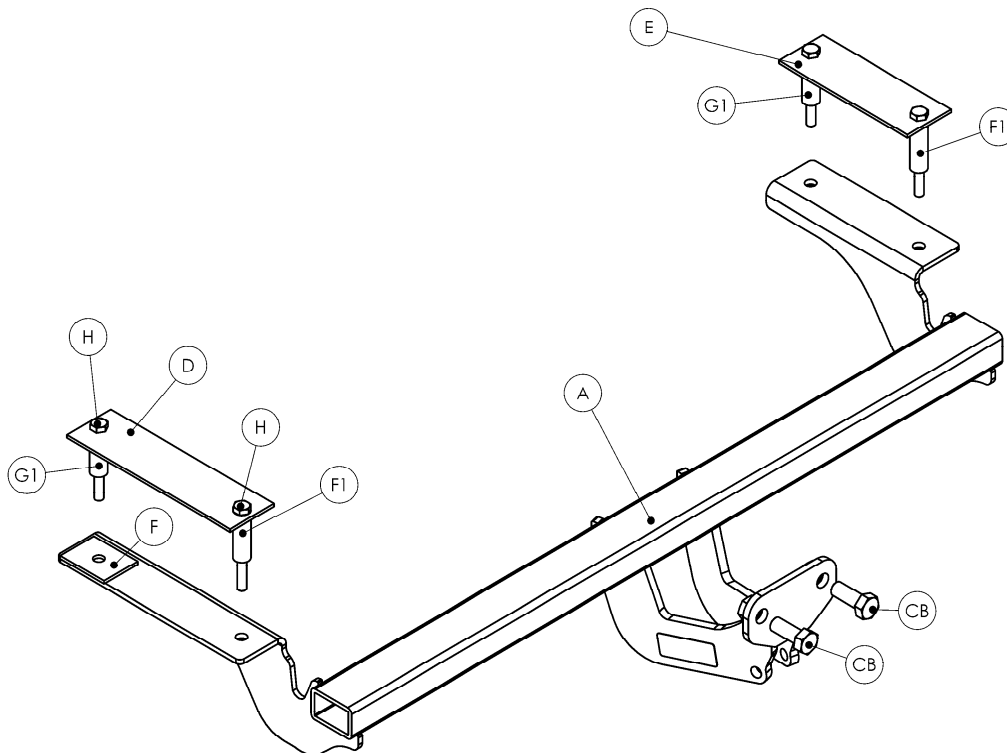

W0001G87B-FIT\$010802220000