



# Fitting Instruction

TOWBAR For **PG44A**  
Peugeot 308 Hatchback  
2007 on

## Important Note:

On some vehicles the tow ball must be removed when not towing as the height the tow ball obscures the rear number plate. This applies to rear bumpers with a black insert design.

## MATERIALS

A	1	Cross Bar
B	1	Right Hand Side Arm
C	1	Left Hand Side Arm
D	1	Bush (OD 25mm, Length 9mm)
F	4	M10x1.50mm Nut, Lock Washer and Flat Washer (30mm O.D.)
G	4	M12x45x1.75mm Bolt, Flat Washer (25mm O.D.), Lock Washer and Nut
H	4	M8x50x1.25mm Set Bolt, Flat Washer (25mm O.D.), Flat Washer (20mm O.D.), Lock Washer and Nut
CB	2	M16 x 50mm Coupling Bolts, Nuts, Lock Washers
Z	1	ZEP35 Electrical plate (not shown)

## FITTING

1. Undo the bolt on the off-centre bumper tag from the underside of the bumper and remove all underside arch plugs.
2. Remove the x3 bolts from the rear panel of the vehicle. Discard and replace with x3 Set Bolts and Flat Washers (25mm O.D.) from fixings (H). **Ensure all forward facing mating areas are free of mastic.**
3. Add a fourth Set Bolt and Flat Washer (25mm O.D.) from fixing (H) to the rear panel, ensuring that Bush (D) sits on the forward face of the rear panel, simulating the thickness of the absent nut. **Please Note:** It may ease fitment if Bolts (H) are only partially threaded before Side arms (B and C) are fitted.
4. Remove lashing eyes, and loosely locate Side Arms (B & C) over the existing horizontal bolts and vertical studs. ( There is an additional slot on side arm (C) to accommodate the rear most exhaust hanger on some vehicles. Use existing fixing)
5. Loosely attach using fixings (F) and the remaining fixings of (H). **Please Note:** It may ease fitment if Fixings (H) on the right hand side are tightened before fitting Cross Bar (A).
6. Carefully feed Crossbar (A) over the exhaust and loosely attach to the sidearm (B & C) using fixings (G). If necessary bend or remove the redundant metal, off centre bumper tag connected to the lower edge of the back panel.
7. Push bumper edge inwards fully before tightening. **Fully tighten all remaining fixings to the recommended torque settings**

**Note:** This towbar must be used with either a Witter Towball (part number Z11) or Class A50-1 or A50-X towball dimensionally Conforming to A50-1 with a 'D' and 'S' value greater than or equal to that of the towbar. Please refer to the vehicle specification for the trailer weight and nose limits, which **must be observed**. **Recommended torque settings:** M8 - 27Nm, M10 - 53 Nm, M12 - 95 Nm, M14 - 150 Nm, M16 - 214 Nm

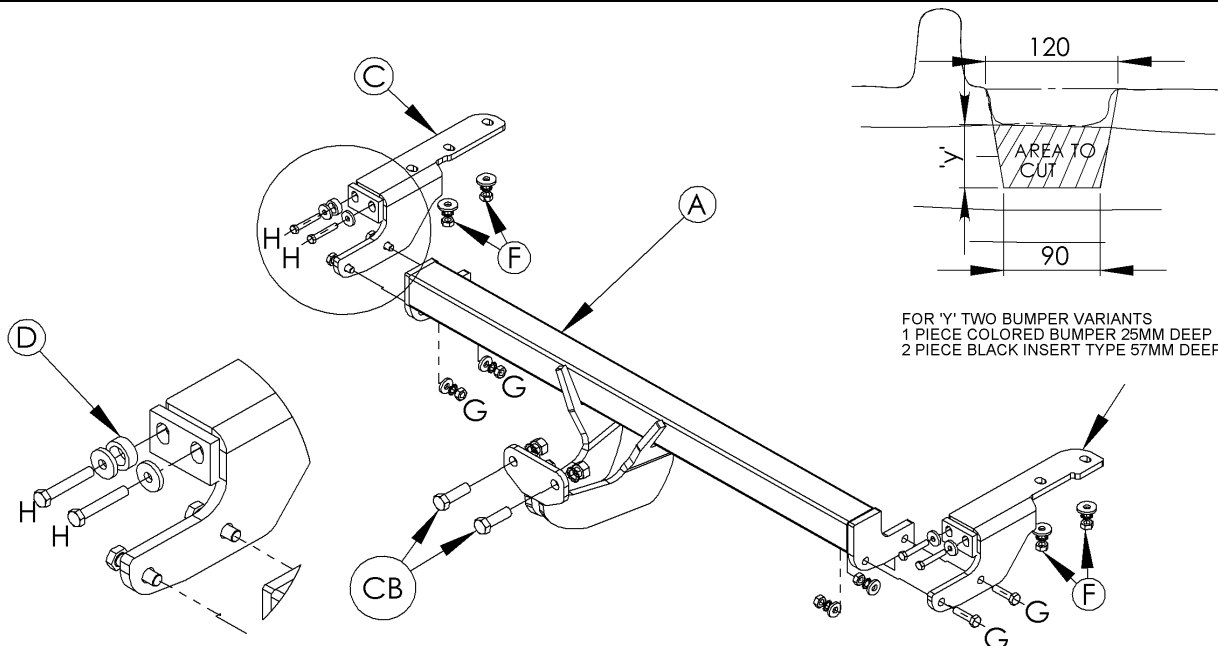

W0001XXXX-FIT\$010802220000

