



Fitting Instructions

TOWBAR R43U
For MG3
2012-

MATERIALS

A	1	Cross Bar
B	1	Long Side Arm
C	1	Short Side Arm
D	2	M12 x 40 x 1.75 Bolts, Lock Washers, and Large Plain Washers (Ø40)
E	2	M10 x 35 x 1.25 Bolts, Lock Washers, 2 x Flat Washers, and Nuts
F	4	M10 x 35 x 1.25 Bolts, Lock Washers, and Flat Washers
G	2	M8 x 1.25 Spigot Nut, 10mm I.D. Lock Washers and 10mm I.D. Flat Washers
H	2	M12 x 40 x 1.75 Bolts, Lock Washers, and Plain Washers
ZE	1	Electrical Plate Bracket
ZN	1	Neck Kit

FITTING

1. Remove bumper
2. Remove Inner Bumper beam.
3. Insert Side Arms (B & C) into open ends of chassis rails until they align with the large holes in the base of the Chassis Rail, and are flush with the vehicle rear panel.
4. Loosely secure each Side Arm (B & C) at their forward-most mounting with fasteners (D)
5. Assemble Cross Bar (A) to rear panel by locating over existing studs. (one each end of Crossbar)
6. Secure Cross Bar (A) to rear panel using Spigot Nut fasteners (G) and fasteners (F) & (E).
7. Secure each Side Arm (B & C) to Cross Bar (A) using fasteners (H).
8. Assemble the Chosen Neck Kit (ZN) and Electrical Plate (ZE) to the upper set of holes in Cross Bar (A) using fasteners in the Neck Kit.
9. **Fully tighten all Fasteners**
10. Depending on which neck kit is fitted cut bumper as shown below and re-fit. Note: For ZFB3006 and ZSE3006 necks twist/spread the bumper about the vertical cut line to fit it around the round section of the neck.

Recommended torque settings:

Grade 8.8 bolts: M8 - 24Nm, M10 - 52 Nm, M12 - 80 Nm, M14 - 130 Nm, M16 - 200 Nm

Grade 10.9: M12 - 120Nm, M10 - 70Nm M8- 35Nm

Bumper cut for:
ZFB3006 and ZSE3006
Neck Kits

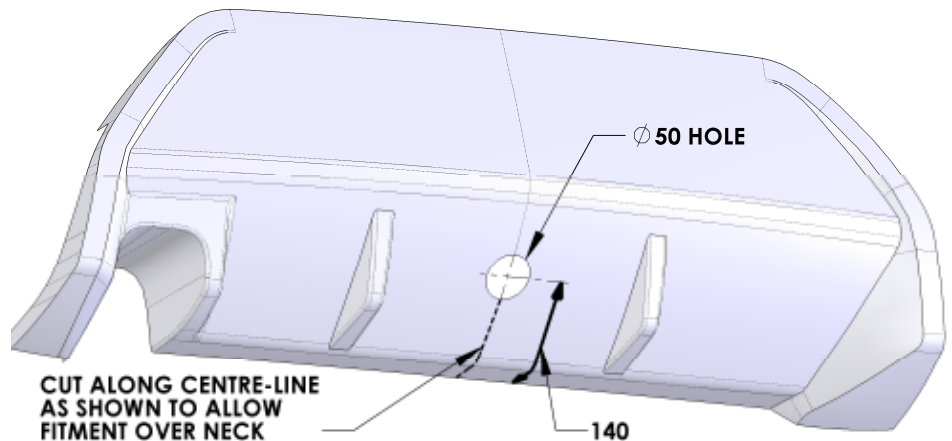

Bumper cut for:
ZQE3006 and ZQFE3006
Neck Kits

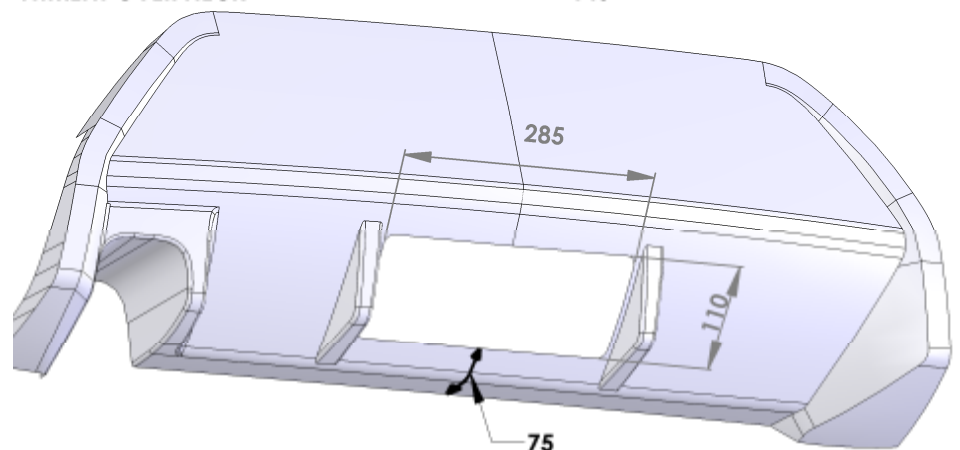

W0001R43U-FIT\$011202120000

